





<div><div><div><div>NLA</div><div>NATIONAL LAND AGENCY</div></div></div><div><div>ADJUDICATION RECORD</div><div>PURSUANT TO SECTION 8A (1) (e) and 8A (1) (g) OF THE REGISTRATION OF TITLES CADASTRAL MAPPING AND TENURE CLARIFICATION (SPECIAL PROVISIONS) ACT</div></div></div>																				
SYSTEMATIC ADJUDICATION AREA : PARTS OF BURNT SAVANNAH CALLED 500 LANE AND GHETTO LANE. St. Elizabeth																				
LAND INFORMATION										PERSONAL DETAILS		OCCUPANCY DETAILS								
APPLICATION NO.	CADASTRAL MAP NUMBER	CADASTRAL MAP PARCEL NUMBER	LAND VALUATION NUMBER	AREA	PLACE	PARISH	VOLUME/FO LIO	PROPERTY ADDRESS	NATURE OF PARCEL	OWNER(S) DETAILS	NATURE BY WHICH LAND WAS ACQUIRED	NATURE OF OWNER DISBAILITY	NAME, ADDRESS AND OCCUPATION OF GUARDIAN	NATURE OF TITLE	DETAILS OF ENCUMBRANCES	RESTRICTIONS ON POWER TO DEAL WITH LAND	DETAILS OF PERSON ENTITLED TO BENEFIT OF RESTRICTION	DOCUMENTS PRESENTED	DATE OF COMPLETION OF APPLICATION FORM	
ASD000543	CM1136040-521	113604005	-	736.0 Square Meter	BURNT SAVANNAH CALLED GHETTO LANE	St. Elizabeth		Mother Vie Lane, Burnt Savannah, St. Elizabeth	Private	- Aneita Powell Alias Ms Neita Retiree of Burnt Savannah District, Burnt Savannah P.A. St. Elizabeth Jamaica	Inheritance			Absolute				- Survey Plan Examination No. : - - Property Tax Receipts	2021-02-19	
ASD000603	CM1136040-521	113604014	-	1194.0 Square Meter	BURNT SAVANNAH CALLED GHETTO LANE	St. Elizabeth		Mother Vie Lane, Burnt Savannah, St. Elizabeth	Private	- Brian Anthony Chambers Alias Mack Caretaker of Dillies Bay, Sandy Banks P.A., Treasure Bay St. Elizabeth Jamaica	Inheritance			Absolute					2021-04-21	
ASD001051	CM1136020-520	113602017	-	1821.0 Square Meter	BURNT SAVANNAH CALLED 500 LANE	St. Elizabeth		Ghetto Lane, Burnt Savannah, St. Elizabeth	Private	- Allan Neil Gardener Farmer of Burnt Savannah District, Burnt Savannah P.A. St. Elizabeth Jamaica	Gift			Absolute					2021-05-17	
ASD000537	CM1136020-520	113602008	-	567.0 Square Meter	BURNT SAVANNAH CALLED 500 LANE	St. Elizabeth		500 Lane, Burnt Savannah, St Elizabeth	Private	- Andrea Nannette Dixon Alias Mel Vendor of Burnt Savannah District, Burnt Savannah P.A. St. Elizabeth Jamaica	Inheritance			Absolute				- Property Tax Receipts	2021-02-17	
ASD000521	CM1136072-523	113607227	-	496.0 Square Meter	BURNT SAVANNAH CALLED GHETTO LANE	St. Elizabeth		Ghetto Lane, Burnt Savannah, St. Elizabeth	Private	- Andrea Nicole Ebanks Alias Terry Farmer of Burnt Savannah District, Burnt Savannah P.A. St. Elizabeth Jamaica	Gift			Absolute	Right of Way			- Property Tax Receipts	2021-02-10	
ASD000499	CM1136020-520	113602019	-	1828.0 Square Meter	BURNT SAVANNAH CALLED 500 LANE	St. Elizabeth		500 Lane, Burnt Savannah, St. Elizabeth	Private	- Anghalia Smith Alias Annie Housewife of Burnt Savannah District, Burnt Savannah P.A. St. Elizabeth Jamaica - Nigel Carlinton Smith Engineer of 8600 Old Cedar Avenue South, Bloomington Minnesota United States - Betsy Mahalia Smith Farmer of Burnt Savannah District, Burnt Savannah P.A. St. Elizabeth Jamaica	Inheritance			Absolute				- Property Tax Receipts - Last Will and Testament of : Malichi Smith - Death Certificate	2021-02-04	
ASD000548	CM1136040-521	113604021	-	352.0 Square Meter	BURNT SAVANNAH CALLED GHETTO LANE	St. Elizabeth		Mother Vie Lane, Burnt Savannah, St. Elizabeth	Private	- Ann Marie Angella Warren Farmer of Burnt Savannah District, Burnt Savannah P.A. St. Elizabeth Jamaica	Inheritance			Absolute				- Property Tax Receipts - Death Certificate	2021-02-19	
ASD000547	CM1136040-521	113604017	-	744.0 Square Meter	BURNT SAVANNAH CALLED GHETTO LANE	St. Elizabeth		Mother Vie Lane, Burnt Savannah, St. Elizabeth	Private	- Ann Marie Angella Warren Farmer of Burnt Savannah District, Burnt Savannah P.A. St. Elizabeth Jamaica	Inheritance			Absolute				- Property Tax Receipts - Death Certificate	2021-02-19	
ASD000573	CM1136040-521	113604006	-	286.0 Square Meter	BURNT SAVANNAH CALLED GHETTO LANE	St. Elizabeth		Mother Vie Lane, Burnt Savannah, St. Elizabeth	Private	- Auldin Hubert Powell Decorator of Burnt Savannah District, Burnt Savannah P.A. St. Elizabeth Jamaica	Gift			Absolute				- Survey Plan Examination No. : - - Property Tax Receipts	2021-03-18	
ASD000559	CM1136040-521	113604011	-	973.0 Square Meter	BURNT SAVANNAH CALLED GHETTO LANE	St. Elizabeth		Mother Vie Lane, Burnt Savannah, St. Elizabeth	Private	- Baldi Manoah Mair Alias Suffy Farmer of Burnt Savannah District, Burnt Savannah P.A. St. Elizabeth Jamaica	Possession			Absolute				- Property Tax Receipts	2021-02-26	
ASD000555	CM1136040-521	113604022	-	2586.0 Square Meter	BURNT SAVANNAH CALLED GHETTO LANE	St. Elizabeth		Mother Vie Lane, Burnt Savannah, St. Elizabeth	Private	- Baldi Manoah Mair Alias Suffy Farmer of Burnt Savannah District, Burnt Savannah P.A. St. Elizabeth Jamaica	Gift			Absolute	Right of Way			- Property Tax Receipts	2021-02-25	
ASD000560	CM1136040-521	113604013	-	1573.0 Square Meter	BURNT SAVANNAH CALLED GHETTO LANE	St. Elizabeth		Mother Vie Lane, Burnt Savannah, St. Elizabeth	Private	- Baldi Manoah Mair Alias Suffy Farmer of Burnt Savannah District, Burnt Savannah P.A. St. Elizabeth Jamaica - Garfield Winston Mairs Farmer of Burnt Savannah District, Burnt Savannah P.A. St. Elizabeth Jamaica	Possession			Absolute				- Property Tax Receipts	2021-02-26	
ASD000542	CM1136020-520	113602034	-	357.0 Square Meter	BURNT SAVANNAH CALLED 500 LANE	St. Elizabeth		500 Lane, Burnt Savannah, St. Elizabeth	Private	- Brenda Patricia Thomas Farmer of Burnt Savannah District, Burnt Savannah P.A. St. Elizabeth Jamaica	Purchase			Absolute					2021-02-17	
ASD000519	CM1136020-520	113602035	-	807.0 Square Meter	BURNT SAVANNAH CALLED 500 LANE	St. Elizabeth		500 Lane, Burnt Savannah, St. Elizabeth	Private	- Brenda Patricia Thomas Farmer of Burnt Savannah District, Burnt Savannah P.A. St. Elizabeth Jamaica	Gift			Absolute					2021-02-10	
ASD000606	CM1136072-523	113607243		2097.0 Square Meter	BURNT SAVANNAH CALLED 500 LANE	St. Elizabeth		Ghetto Lane, Burnt Savannah, St. Elizabeth	Private	- Calfa Medley Miles Manager of 3289 Osprey Lane, West Palm Beach Florida United States - Paulette Victoria Miles Nurses Aide of 970 SW 50th Way, Margate Florida United States - Desirée Carrie Miles Education Administrator of 12317 Sannenwood Lane, Wellington Florida United States - Clive Franklyn Miles Auto Technician of 5070 Unit D Elmhurst Road, West Palm Beach Florida United States	Inheritance			Qualified						2021-04-26
ASD000498	CM1136020-520	113602007	-	610.0 Square Meter	BURNT SAVANNAH CALLED 500 LANE	St. Elizabeth		500 Lane, Burnt Savannah, St. Elizabeth	Private	- Carolyn Ann Marie Dixon Alias Michelle Farmer of Burnt Savannah District, Burnt Savannah P.A. St. Elizabeth Jamaica	Inheritance			Absolute				- Property Tax Receipts - Agreement for Sale	2021-02-04	

<div><div><div><div>NATIONAL LAND AGENCY</div></div></div><div><div>ADJUDICATION RECORD</div><div>PURSUANT TO SECTION 8A (1) (a) and 8A (1) (g) OF THE REGISTRATION OF TITLES CADASTRAL MAPPING AND TENURE CLARIFICATION (SPECIAL PROVISIONS) ACT</div></div></div>																			
SYSTEMATIC ADJUDICATION AREA : PARTS OF BURNT SAVANNAH CALLED 500 LANE AND GHETTO LANE. St. Elizabeth																			
APPLICATION NO.	CADASTRAL MAP NUMBER	CADASTRAL MAP PARCEL NUMBER	LAND VALUATION NUMBER	AREA	PLACE	PARISH	VOLUME/FO LIO	PROPERTY ADDRESS	NATURE OF PARCEL	PERSONAL DETAILS			OCCUPANCY DETAILS						
										OWNER(S) DETAILS	NATURE BY WHICH LAND WAS ACQUIRED	NATURE OF OWNER DISABILITY	NAME, ADDRESS AND OCCUPATION OF GUARDIAN	NATURE OF TITLE	DETAILS OF ENCUMBRANCES	RESTRICTIONS ON POWER TO DEAL WITH LAND	DETAILS OF PERSON ENTITLED TO BENEFIT OF RESTRICTION	DOCUMENTS PRESENTED	DATE OF COMPLETION OF APPLICATION FORM
ASD000510	CM1136020-520	113602054	-	1845.0 Square Meter	BURNT SAVANNAH CALLED 500 LANE	St. Elizabeth		500 Lane, Burnt Savannah, St. Elizabeth	Private	- Charles Foster Alias Joe Foster Retiree of Burnt Savannah District, Burnt Savannah P.A. St. Elizabeth Jamaica	Possession			Absolute				- Survey Plan Examination No. : PE336220 - Property Tax Receipts	2021-02-05
ASD000527	CM1136071-522	113607109	-	1030.0 Square Meter	BURNT SAVANNAH CALLED GHETTO LANE	St. Elizabeth		Ghetto Lane, Burnt Savannah, St. Elizabeth	Private	- Charmain Angella Patterson Vendor of Burnt Savannah District, Burnt Savannah P.A. St. Elizabeth Jamaica	Inheritance			Qualified				- Death Certificate	2021-02-10
ASD000579	CM1136072-523	113607219	-	1417.0 Square Meter	BURNT SAVANNAH CALLED GHETTO LANE	St. Elizabeth		Ghetto Lane, Burnt Savannah, St. Elizabeth	Private	- Christine Angella Francis Dressmaker of Burnt Savannah District, Burnt Savannah P.A. St. Elizabeth Jamaica - Daneil Dexroy Simms Carver of Burnt Savannah District, Burnt Savannah P.A. St. Elizabeth Jamaica - Wesley Deer Alias Gigin or Brown Farmer of Burnt Savanannah District, Burnt Savannah P.A. St. Elizabeth Jamaica	Inheritance			Qualified				- Property Tax Receipts - Death Certificate	2021-03-23
ASD000567	CM1136072-523	113607257	-	1265.0 Square Meter	BURNT SAVANNAH CALLED GHETTO LANE	St. Elizabeth		Ghetto Lane, Burnt Savannah, St. Elizabeth	Private	- Claston Egbert Bernard Maintenance Worker of 1510 Stacy Avenue, Gonzales Louisiana United States	Inheritance			Absolute				- Last Will and Testament of : Mathania Maxwell - Grant of Administration : Mathania Maxwell	2021-03-15
ASD000505	CM1136020-520	113602015	-	424.0 Square Meter	BURNT SAVANNAH CALLED 500 LANE	St. Elizabeth		500 Lane, Burnt Savannah, St. Elizabeth	Private	- Cleve Taylor Alias Tan Farmer of Burnt Savannah District, Burnt Savannah P.A. St. Elizabeth Jamaica	Possession			Absolute	Right of Way				2021-02-04
ASD001058	CM1136072-523	113607234	-	492.0 Square Meter	BURNT SAVANNAH CALLED GHETTO LANE	St. Elizabeth		Ghetto Lane, Burnt Savannah, St. Elizabeth	Crown	- Commissioner of Lands A Corporation Sole established and existing under and by virtue of the provisions of the Crown Property (Vesting) Act of 20 North Street Kingston Jamaica	Special Provisions Act			Absolute					2021-05-17
ASD001057	CM1136072-523	113607221	-	714.0 Square Meter	BURNT SAVANNAH CALLED GHETTO LANE	St. Elizabeth		Ghetto Lane, Burnt Savannah, St. Elizabeth	Crown	- Commissioner of Lands A Corporation Sole established and existing under and by virtue of the provisions of the Crown Property (Vesting) Act of 20 North Street Kingston Jamaica	Special Provisions Act			Absolute					2021-05-17
ASD001056	CM1136072-523	113607215	-	4857.0 Square Meter	BURNT SAVANNAH CALLED GHETTO LANE	St. Elizabeth		Ghetto Lane, Burnt Savannah, St. Elizabeth	Crown	- Commissioner of Lands A Corporation Sole established and existing under and by virtue of the provisions of the Crown Property (Vesting) Act of 20 North Street Kingston Jamaica	Special Provisions Act			Absolute					2021-05-17
ASD001055	CM1136072-523	113607203	-	1376.0 Square Meter	BURNT SAVANNAH CALLED GHETTO LANE	St. Elizabeth		Ghetto Lane, Burnt Savannah, St. Elizabeth	Crown	- Commissioner of Lands A Corporation Sole established and existing under and by virtue of the provisions of the Crown Property (Vesting) Act of 20 North Street Kingston Jamaica	Special Provisions Act			Absolute					2021-05-17
ASD001054	CM1136072-523	113607205	-	1928.0 Square Meter	BURNT SAVANNAH CALLED GHETTO LANE	St. Elizabeth		Ghetto Lane, Burnt Savannah, St. Elizabeth	Crown	- Commissioner of Lands A Corporation Sole established and existing under and by virtue of the provisions of the Crown Property (Vesting) Act of 20 North Street Kingston Jamaica	Special Provisions Act			Absolute					2021-05-17
ASD001050	CM1136072-523	113607206	-	778.0 Square Meter	BURNT SAVANNAH CALLED GHETTO LANE	St. Elizabeth		Ghetto Lane, Burnt Savannah, St. Elizabeth	Crown	- Commissioner of Lands A Corporation Sole established and existing under and by virtue of the provisions of the Crown Property (Vesting) Act of 20 North Street Kingston Jamaica	Special Provisions Act			Absolute					2021-05-17
ASD001032	CM1136020-520	113602052	-	1263.0 Square Meter	BURNT SAVANNAH CALLED 500 LANE	St. Elizabeth		500 Lane, Burnt Savannah, St. Elizabeth	Crown	- Commissioner of Lands A Corporation Sole established and existing under and by virtue of the provisions of the Crown Property (Vesting) Act of 20 North Street Kingston Jamaica	Special Provisions Act			Absolute					2021-05-09
ASD001031	CM1136020-520	113602051	-	2658.0 Square Meter	BURNT SAVANNAH CALLED 500 LANE	St. Elizabeth		500 Lane, Burnt Savannah, St. Elizabeth	Crown	- Commissioner of Lands A Corporation Sole established and existing under and by virtue of the provisions of the Crown Property (Vesting) Act of 20 North Street Kingston Jamaica	Special Provisions Act			Absolute					2021-05-09
ASD000574	CM1136020-520	113602055	-	2254.0 Square Meter	BURNT SAVANNAH CALLED 500 LANE	St. Elizabeth		500 Lane, Burnt Savannah, St. Elizabeth	Crown	- Commissioner of Lands A Corporation Sole established and existing under and by virtue of the provisions of the Crown Property (Vesting) Act of 20 North Street Kingston Jamaica	Special Provisions Act			Absolute					2021-03-23
ASD000566	CM1136071-522	113607110	-	1283.0 Square Meter	BURNT SAVANNAH CALLED GHETTO LANE	St. Elizabeth		Ghetto Lane, Burnt Savannah, St. Elizabeth	Private	- Cover Augustus Morrison Farmer of Burnt Savannah District, Burnt Savannah P.A. St. Elizabeth Jamaica	Purchase			Absolute				- Survey Plan Examination No. : 104183	2021-03-05

<div><div><div><div>NATIONAL LAND AGENCY</div></div></div><div><div>ADJUDICATION RECORD</div><div>PURSUANT TO SECTION 8A (1) (e) and 8A (1) (g) OF THE REGISTRATION OF TITLES CADASTRAL MAPPING AND TENURE CLARIFICATION (SPECIAL PROVISIONS) ACT</div></div></div>																			
SYSTEMATIC ADJUDICATION AREA : PARTS OF BURNT SAVANNAH CALLED 500 LANE AND GHETTO LANE. St. Elizabeth																			
LAND INFORMATION										PERSONAL DETAILS			OCCUPANCY DETAILS						
APPLICATION NO.	CADASTRAL MAP NUMBER	CADASTRAL MAP PARCEL NUMBER	LAND VALUATION NUMBER	AREA	PLACE	PARISH	VOLUME/FO LIO	PROPERTY ADDRESS	NATURE OF PARCEL	OWNER(S) DETAILS	NATURE BY WHICH LAND WAS ACQUIRED	NATURE OF OWNER DISABILITY	NAME, ADDRESS AND OCCUPATION OF GUARDIAN	NATURE OF TITLE	DETAILS OF ENCUMBRANCES	RESTRICTIONS ON POWER TO DEAL WITH LAND	DETAILS OF PERSON ENTITLED TO BENEFIT OF RESTRICTION	DOCUMENTS PRESENTED	DATE OF COMPLETION OF APPLICATION FORM
ASD000525	CM1136071-522	113607113	-	1964.0 Square Meter	BURNT SAVANNAH CALLED GHETTO LANE	St. Elizabeth		Ghetto Lane, Burnt Savannah, St. Elizabeth	Private	- Cover Augustus Morrison Farmer of Burnt Savannah District, Burnt Savannah P.A. St. Elizabeth Jamaica	Purchase			Absolute				- Receipt	2021-02-10
ASD000524	CM1136071-522	113607111	-	1268.0 Square Meter	BURNT SAVANNAH CALLED GHETTO LANE	St. Elizabeth		Ghetto Lane, Burnt Savannah, St. Elizabeth	Private	- Cover Augustus Morrison Farmer of Burnt Savannah District, Burnt Savannah P.A. St. Elizabeth Jamaica	Purchase			Absolute				- Survey Plan Examination No. : 104183	2021-02-10
ASD000565	CM1136071-522	113607112	-	1448.0 Square Meter	BURNT SAVANNAH CALLED GHETTO LANE	St. Elizabeth		Ghetto Lane, Burnt Savannah, St. Elizabeth	Private	- Cover Augustus Morrison Farmer of Burnt Savannah District, Burnt Savannah P.A. St. Elizabeth Jamaica - Ivette Louise Morrison Housewife of Burnt Savannah District, Burnt Savannah P.A. St. Elizabeth Jamaica	Purchase			Absolute					2021-03-04
ASD000522	CM1136071-522	113607114	-	1002.0 Square Meter	BURNT SAVANNAH CALLED GHETTO LANE	St. Elizabeth		Ghetto Lane, Burnt Savannah, St. Elizabeth	Private	- Cover Augustus Morrison Farmer of Burnt Savannah District, Burnt Savannah P.A. St. Elizabeth Jamaica - Ivette Louise Morrison Housewife of Burnt Savannah District, Burnt Savannah P.A. St. Elizabeth Jamaica	Purchase			Absolute				- Survey Plan Examination No. : 104183	2021-02-10
ASD001052	CM1136072-523	113607252	-	1960.0 Square Meter	BURNT SAVANNAH CALLED GHETTO LANE	St. Elizabeth		Ghetto Lane, Burnt Savannah, St. Elizabeth	Private	- Cuban Balfore Powell Retired Security Officer of 1812 Washington Circle, Cincinatti Ohio United States	Purchase			Absolute					2021-05-17
ASD000551	CM1136072-523	113607241	-	806.0 Square Meter	BURNT SAVANNAH CALLED GHETTO LANE	St. Elizabeth		Ghetto Lane, Burnt Savannah, St. Elizabeth	Private	- Curtis Daniel Bernard Alias Junior Mechanic of Burnt Savannah District, Burnt Savannah P.A. St. Elizabeth Jamaica	Purchase			Absolute				- Property Tax Receipts - Receipt	2021-02-22
ASD000534	CM1136072-523	113607240	-	490.0 Square Meter	BURNT SAVANNAH CALLED GHETTO LANE	St. Elizabeth		Ghetto Lane, Burnt Savannah, St. Elizabeth	Private	- Curtis Daniel Bernard Alias Junior Mechanic of Burnt Savannah District, Burnt Savannah P.A. St. Elizabeth Jamaica	Purchase			Absolute				- Property Tax Receipts - Receipt	2021-02-17
ASD000506	CM1136020-520	113602012	-	342.0 Square Meter	BURNT SAVANNAH CALLED 500 LANE	St. Elizabeth		500 Lane, Burnt Savannah, St. Elizabeth	Private	- Davia Danesha Wiggan Alias Angel Unemployed of Burnt Savannah District, Burnt Savannah P.A. St. Elizabeth Jamaica	Inheritance			Absolute				- Property Tax Receipts - Birth Certificate	2021-02-04
ASD000556	CM1136072-523	113607254	-	1971.0 Square Meter	BURNT SAVANNAH CALLED GHETTO LANE	St. Elizabeth		Ghetto Lane, Burnt Savannah, St. Elizabeth	Private	- Dawn Morine Mitchell-Lundy Housekeeper of 7a Ocean Wood Avenue, Freeport, Grand Bahama Bahamas - Paulette Rose Mitchell-Carey Housewife of 111 Clive Avenue, Freeport Grand Bahama Bahamas	Purchase			Absolute					2021-02-25
ASD000531	CM1136072-523	113607209	-	891.0 Square Meter	BURNT SAVANNAH CALLED GHETTO LANE	St. Elizabeth		Ghetto Lane, Burnt Savannah, St. Elizabeth	Private	- Deana Dawn Thomas Housewife of Burnt Savannah District, Burnt Savannah P.A. St. Elizabeth Jamaica - Nicole Peter-Ann Thomas Farmer of Burnt Savannah District, Burnt Savannah P.A. St. Elizabeth Jamaica - Tamar Feronie Thomas Unemployed of Burnt Savannah District, Burnt Savannah P.A. St. Elizabeth Jamaica - Simone Samantha Thomas Billing Clerk of Burnt Savannah District, Burnt Savannah P.A. St. Elizabeth Jamaica	Inheritance			Absolute				- Property Tax Receipts - Marriage Certificate	2021-02-12
ASD000533	CM1136020-520	113602009	-	390.0 Square Meter	BURNT SAVANNAH CALLED 500 LANE	St. Elizabeth		500 Lane, Burnt Savannah, St Elizabeth	Private	- Deborah Dacosta Alias Suzie Farmer of Burnt Savannah District, Burnt Savannah P.A. St. Elizabeth Jamaica	Gift			Absolute				- Survey Plan Examination No. : property tax receipts,indenture	2021-02-12
ASD000601	CM1136072-523	113607212	-	1138.0 Square Meter	BURNT SAVANNAH CALLED GHETTO LANE	St. Elizabeth		Ghetto Lane, Burnt Savannah, St. Elizabeth	Private	- Delroy Anthony Thomas Alias Erkie Chef of 840 Marlyn Road, Philidephia Pennsylvania United States	Inheritance			Absolute					2021-04-21
ASD000539	CM1136020-520	113602021		493.0 Square Meter	BURNT SAVANNAH CALLED 500 LANE	St. Elizabeth		500 Lane, Burnt Savannah, St. Elizabeth	Private	- Derick Banton Farmer of Burnt Savannah District, Burnt Savannah P.A. St. Elizabeth Jamaica	Purchase			Absolute					2021-02-17
ASD000587	CM1136020-520	113602030	-	1386.0 Square Meter	BURNT SAVANNAH CALLED 500 LANE	St. Elizabeth		500 Lane, Burnt Savannah, St. Elizabeth	Private	- Donald Sylvester Cornwall Businessman of Burnt Savannah District, Burnt Savannah P.A. St. Elizabeth Jamaica	Purchase			Absolute					2021-03-24
ASD000530	CM1136072-523	113607214	-	1199.0 Square Meter	BURNT SAVANNAH CALLED GHETTO LANE	St. Elizabeth		Ghetto Lane, Burnt Savannah, St. Elizabeth	Private	- Eddison Fitzroy Thomas Alias Burry boy Steward of Burnt Savannah District, Burnt Savannah P.A. St. Elizabeth Jamaica	Inheritance			Absolute				- Property Tax Receipts	2021-02-12
ASD000575	CM1136020-520	113602024	-	1152.0 Square Meter	BURNT SAVANNAH CALLED 500 LANE	St. Elizabeth		500 Lane, Burnt Savannah, St. Elizabeth	Private	- Edward Elijah Butt Retiree of 216 North James Street, Peekskill New York United States	Purchase			Absolute					2021-03-23

<div><div><div><div>NATIONAL LAND AGENCY</div></div></div><div><div>ADJUDICATION RECORD</div><div>PURSUANT TO SECTION 8A (1) (e) and 8A (1) (g) OF THE REGISTRATION OF TITLES CADASTRAL MAPPING AND TENURE CLARIFICATION (SPECIAL PROVISIONS) ACT</div></div></div>																			
SYSTEMATIC ADJUDICATION AREA : PARTS OF BURNT SAVANNAH CALLED 500 LANE AND GHETTO LANE. St. Elizabeth																			
LAND INFORMATION										PERSONAL DETAILS			OCCUPANCY DETAILS						
APPLICATION NO.	CADASTRAL MAP NUMBER	CADASTRAL MAP PARCEL NUMBER	LAND VALUATION NUMBER	AREA	PLACE	PARISH	VOLUME/FO LIO	PROPERTY ADDRESS	NATURE OF PARCEL	OWNER(S) DETAILS	NATURE BY WHICH LAND WAS ACQUIRED	NATURE OF OWNER DISBAILITY	NAME, ADDRESS AND OCCUPATION OF GUARDIAN	NATURE OF TITLE	DETAILS OF ENCUMBRANCES	RESTRICTIONS ON POWER TO DEAL WITH LAND	DETAILS OF PERSON ENTITLED TO BENEFIT OF RESTRICTION	DOCUMENTS PRESENTED	DATE OF COMPLETION OF APPLICATION FORM
ASD000554	CM1136040-521	113604034	-	1323.0 Square Meter	BURNT SAVANNAH CALLED GHETTO LANE	St. Elizabeth		Mother Vie Lane, Burnt Savannah, St. Elizabeth	Private	- Elveta Beatrice Banton Alias Pungier Housewife of Burnt Savannah District, Burnt Savannah P.A. St. Elizabeth Jamaica	Inheritance			Absolute				- Last Will and Testament of : Daniel Morrison	2021-02-25
ASD000597	CM1136040-521	113604012	-	2112.0 Square Meter	BURNT SAVANNAH CALLED GHETTO LANE	St. Elizabeth		Mother Vie Lane, Burnt Savannah, St. Elizabeth	Private	- Eric Anthony Dunkley Alias Kernel Willy Farmer of Burnt Savannah District, Burnt Savannah P.A. St. Elizabeth Jamaica - Leroy Dunkley Alias Feather Farmer of Burnt Savannah District, Burnt Savannah P.A. St. Elizabeth Jamaica	Inheritance			Qualified					2021-04-21
ASD000553	CM1136071-522	113607106	-	1950.0 Square Meter	BURNT SAVANNAH CALLED GHETTO LANE	St. Elizabeth		Ghetto Lane, Burnt Savannah, St. Elizabeth	Private	- Ezena Elaine Montgomery Certified Nurse Assistant of 2533 Lodovick Avenue, Bronx New York United States	Inheritance			Absolute				- Survey Plan Examination No. : 179292 - Property Tax Receipts	2021-02-25
ASD000518	CM1136020-520	113602010	-	598.0 Square Meter	BURNT SAVANNAH CALLED 500 LANE	St. Elizabeth		500 Lane, Burnt Savannah, St. Elizabeth	Private	- Ezra Wilesley Dixon Alias Son Son Farmer of Burnt Savannah District, Burnt Savannah P.A. St. Elizabeth Jamaica	Gift			Absolute				- Property Tax Receipts	2021-02-10
ASD000586	CM1136020-520	113602056	-	1855.0 Square Meter	BURNT SAVANNAH CALLED 500 LANE	St. Elizabeth		500 Lane, Burnt Savannah, St. Elizabeth	Private	- Frederick Brown Retired of Burnt Savannah District, Burnt Savannah P.A. St. Elizabeth Jamaica	Inheritance			Absolute				- Property Tax Receipts - Last Will and Testament of : Ronald Allen	2021-03-23
ASD000545	CM1136040-521	113604009	-	295.0 Square Meter	BURNT SAVANNAH CALLED GHETTO LANE	St. Elizabeth		Mother Vie Lane, Burnt Savannah, St. Elizabeth	Private	- Fredie Jordan Powell Mason of Burnt Savannah District, Burnt Savannah P.A. St. Elizabeth Jamaica	Gift			Absolute				- Survey Plan Examination No. : - - Property Tax Receipts	2021-02-19
ASD001043	CM1136040-521	113604023	-	2520.0 Square Meter	BURNT SAVANNAH CALLED GHETTO LANE	St. Elizabeth		Ghetto Lane, Burnt Savannah, St. Elizabeth	Private	- Garfield Winston Mairs Farmer of Burnt Savannah District, Burnt Savannah P.A. St. Elizabeth Jamaica - Delcine Levy-Mairs Treasury Analyst of Burnt Savannah District, Burnt Savannah P.A. St. Elizabeth Jamaica	Inheritance			Absolute					2021-05-15
ASD000582	CM1136040-521	113604008	-	172.0 Square Meter	BURNT SAVANNAH CALLED GHETTO LANE	St. Elizabeth		Mother Vie Lane, Burnt Savannah, St. Elizabeth	Private	- Glen Powell Carpenter of Burnt Savannah District, Burnt Savannah P.A. St. Elizabeth Jamaica	Gift			Absolute				- Survey Plan Examination No. : - - Property Tax Receipts	2021-03-23
ASD000558	CM1136040-521	113604033	-	1481.0 Square Meter	BURNT SAVANNAH CALLED GHETTO LANE	St. Elizabeth		Mother Vie Lane, Burnt Savannah, St. Elizabeth	Private	- Glenroy Augustus Morrison Vendor of Burnt Savannah District, Burnt Savannah P.A. St. Elizabeth Jamaica	Inheritance			Absolute				- Last Will and Testament of : Daniel Morrison	2021-02-26
ASD000513	CM1136072-523	113607224	-	2150.0 Square Meter	BURNT SAVANNAH CALLED GHETTO LANE	St. Elizabeth		Ghetto Lane, Burnt Savannah, St. Elizabeth	Private	- Hezekiah Augustus Banton Alias Son Bandon Farmer of Burnt Savannah District, Burnt Savannah P.A. St. Elizabeth Jamaica - Galvie Retinella Banton Domestic Helper of Burnt Savannah District, Burnt Savannah P.A. St. Elizabeth Jamaica	Gift			Absolute	Right of Way				2021-02-07
ASD000511	CM1136072-523	113607225	-	1275.0 Square Meter	BURNT SAVANNAH CALLED GHETTO LANE	St. Elizabeth		Ghetto Lane, Burnt Savannah, St. Elizabeth	Private	- Hezekiah Augustus Banton Alias Son Bandon Farmer of Burnt Savannah District, Burnt Savannah P.A. St. Elizabeth Jamaica - Galvie Retinella Banton Domestic Helper of Burnt Savannah District, Burnt Savannah P.A. St. Elizabeth Jamaica	Purchase			Absolute	Right of Way				2021-02-05
ASD000581	CM1136040-521	113604010	-	285.0 Square Meter	BURNT SAVANNAH CALLED GHETTO LANE	St. Elizabeth		Mother Vie Lane, Burnt Savannah, St. Elizabeth	Private	- James Leonard Powell Alias Lenny Minister of Religion of Burnt Savannah District, Burnt Savannah P.A. St. Elizabeth Jamaica	Gift			Absolute				- Survey Plan Examination No. : - - Property Tax Receipts	2021-03-23
ASD001049	CM1136020-520	113602018	-	2456.0 Square Meter	BURNT SAVANNAH CALLED 500 LANE	St. Elizabeth		500 Lane, Burnt Savannah, St. Elizabeth	Private	- Jervis Daley Carpenter of 1 Havelock Crescent, Telford Shropshire United Kingdom	Gift			Qualified					2021-05-17
ASD000564	CM1136020-520	113602014		1244.0 Square Meter	BURNT SAVANNAH CALLED 500 LANE	St. Elizabeth		500 Lane, Burnt Savannah, St. Elizabeth	Private	- Joseph Herberth Levene Alias Danny Chef of Burnt Savannah District, Burnt Savannah P.A. St. Elizabeth Jamaica - Effeston St Clare Levene Alias Babsy Retired Policeman of Lot 285 4th Salmon Way Braeton Phase 1, Bridgeport P.O. St. Catherine Jamaica	Inheritance			Qualified	Right of Way			- Survey Plan Examination No. : 167185 - Last Will and Testament of : George Levene	2021-03-03
ASD000593	CM1136072-523	113607204	-	868.0 Square Meter	BURNT SAVANNAH CALLED GHETTO LANE	St. Elizabeth		Ghetto Lane, Burnt Savannah, St. Elizabeth	Private	- Judian Williams Alias Miss Pibbs Daycare assistant of 445 North 65th Street, Philadelphia Pennsylvania United States	Purchase			Absolute				- Survey Plan Examination No. : 237078	2021-04-21

<div><div><div><div><div><div></div></div></div><div><div><div></div><div><div>NLA</div></div><div><div>NATIONAL LAND AGENCY</div></div></div></div></div></div><div>ADJUDICATION RECORD</div><div>PURSUANT TO SECTION 8A (1) (e) and 8A (1) (g) OF THE</div><div>REGISTRATION OF TITLES CADASTRAL MAPPING AND TENURE CLARIFICATION (SPECIAL PROVISIONS) ACT</div></div>																			
SYSTEMATIC ADJUDICATION AREA : PARTS OF BURNT SAVANNAH CALLED 500 LANE AND GHETTO LANE. St. Elizabeth																			
LAND INFORMATION										PERSONAL DETAILS			OCCUPANCY DETAILS						
APPLICATION NO.	CADASTRAL MAP NUMBER	CADASTRAL MAP PARCEL NUMBER	LAND VALUATION NUMBER	AREA	PLACE	PARISH	VOLUME/FO LJO	PROPERTY ADDRESS	NATURE OF PARCEL	OWNER(S) DETAILS	NATURE BY WHICH LAND WAS ACQUIRED	NATURE OF OWNER DISBAILITY	NAME, ADDRESS AND OCCUPATION OF GUARDIAN	NATURE OF TITLE	DETAILS OF ENCUMBRANCES	RESTRICTIONS ON POWER TO DEAL WITH LAND	DETAILS OF PERSON ENTITLED TO BENEFIT OF RESTRICTION	DOCUMENTS PRESENTED	DATE OF COMPLETION OF APPLICATION FORM
ASD001042	CM1136072-523	113607245	-	947.0 Square Meter	BURNT SAVANNAH CALLED GHETTO LANE	St. Elizabeth		Ghetto Lane, Burnt Savannah, St. Elizabeth	Private	- Kadian Butler Teacher of Lot 58A Haughton Grove, Ramble P.O. St. Elizabeth Jamaica	Inheritance			Absolute					2021-05-15
ASD000514	CM1136072-523	113607222	-	503.0 Square Meter	BURNT SAVANNAH CALLED GHETTO LANE	St. Elizabeth		Ghetto Lane, Burnt Savannah, St. Elizabeth	Private	- Kersha Fiona Taylor-Dunkley Dressmaker of Burnt Savannah District, Burnt Savannah P.A. St. Elizabeth Jamaica - Earl Merrick Dunkley Taxi Operator of Burnt Savannah District, Burnt Savannah P.A. St. Elizabeth Jamaica	Purchase			Absolute				- Survey Plan Examination No. : PE315870 - Property Tax Receipts - Receipt - Utility Bills	2021-02-10
ASD000588	CM1136020-520	113602040	-	1060.0 Square Meter	BURNT SAVANNAH CALLED 500 LANE	St. Elizabeth		500 Lane, Burnt Savannah, St. Elizabeth	Private	- Kyon Andre St Elmo Dunkley Truck Driver of Burnt Savannah District, Burnt Savannah P.A. St. Elizabeth Jamaica	Purchase			Absolute				- Property Tax Receipts - Receipt - Birth Certificate	2021-03-24
ASD000585	CM1136072-523	113607258	-	2267.0 Square Meter	BURNT SAVANNAH CALLED GHETTO LANE	St. Elizabeth		Ghetto Lane, Burnt Savannah, St. Elizabeth	Private	- Lanal Othniel Robinson Alias Cawchie Farmer of Burnt Savannah District, Burnt Savannah P.A. St. Elizabeth Jamaica	Purchase			Absolute					2021-03-23
ASD000584	CM1136072-523	113607259	-	2003.0 Square Meter	BURNT SAVANNAH CALLED GHETTO LANE	St. Elizabeth		Ghetto Lane, Burnt Savannah, St. Elizabeth	Private	- Lanal Othniel Robinson Alias Cawchie Farmer of Burnt Savannah District, Burnt Savannah P.A. St. Elizabeth Jamaica	Purchase			Absolute					2021-03-23
ASD000500	CM1136020-520	113602022	-	1320.0 Square Meter	BURNT SAVANNAH CALLED 500 LANE	St. Elizabeth		500 Lane, Burnt Savannah, St. Elizabeth	Private	- Latoya Amoy Smith Teacher of Burnt Savannah District, Burnt Savannah P.A. St. Elizabeth Jamaica	Purchase			Absolute				- Survey Plan Examination No. : 363279	2021-02-04
ASD000592	CM1136072-523	113607208	-	776.0 Square Meter	BURNT SAVANNAH CALLED GHETTO LANE	St. Elizabeth		Ghetto Lane, Burnt Savannah, St. Elizabeth	Private	- Lenston Thomas Alias Skinny/ Twilight Dietician of 3125 West 75th Street, Los Angeles California United States	Inheritance			Absolute					2021-04-21
ASD000591	CM1136072-523	113607207	-	1129.0 Square Meter	BURNT SAVANNAH CALLED GHETTO LANE	St. Elizabeth		Ghetto Lane, Burnt Savannah, St. Elizabeth	Private	- Lenston Thomas Alias Skinny/ Twilight Dietician of 3125 West 75th Street, Los Angeles California United States	Inheritance			Absolute					2021-04-21
ASD000509	CM1136020-520	113602036	-	384.0 Square Meter	BURNT SAVANNAH CALLED 500 LANE	St. Elizabeth		500 Lane, Burnt Savannah, St. Elizabeth	Private	- Leon Marlon Thomas Alias Shawn Cabinet Maker of Burnt Savannah District, Burnt Savannah P.A. St. Elizabeth Jamaica	Possession			Qualified					2021-02-04
ASD000502	CM1136020-520	113602037	-	368.0 Square Meter	BURNT SAVANNAH CALLED 500 LANE	St. Elizabeth		500 Lane, Burnt Savannah, St. Elizabeth	Private	- Leon Marlon Thomas Alias Shawn Cabinet Maker of Burnt Savannah District, Burnt Savannah P.A. St. Elizabeth Jamaica	Inheritance			Absolute					2021-02-04
ASD000607	CM1136072-523	113607238	-	1049.0 Square Meter	BURNT SAVANNAH CALLED GHETTO LANE	St. Elizabeth		Ghetto Lane, Burnt Savannah, St. Elizabeth	Private	- Lloyd Nathaniel Thomas Alias Castro Farmer of Burnt Savannah District, Burnt Savannah P.A. St. Elizabeth Jamaica	Inheritance			Absolute					2021-04-27
ASD000538	CM1136020-520	113602020	-	739.0 Square Meter	BURNT SAVANNAH CALLED 500 LANE	St. Elizabeth		500 Lane, Burnt Savannah, St. Elizabeth	Private	- Lloyd Nathaniel Thomas Alias Castro Farmer of Burnt Savannah District, Burnt Savannah P.A. St. Elizabeth Jamaica	Purchase			Absolute				- Survey Plan Examination No. : 347077 - Property Tax Receipts	2021-02-17
ASD000526	CM1136072-523	113607260	-	1335.0 Square Meter	BURNT SAVANNAH CALLED GHETTO LANE	St. Elizabeth		Ghetto Lane, Burnt Savannah, St. Elizabeth	Private	- Lloyd Nathaniel Thomas Alias Castro Farmer of Burnt Savannah District, Burnt Savannah P.A. St. Elizabeth Jamaica	Purchase			Absolute				- Property Tax Receipts	2021-02-10
ASD000594	CM1136072-523	113607220	-	3230.0 Square Meter	BURNT SAVANNAH CALLED GHETTO LANE	St. Elizabeth		Ghetto Lane, Burnt Savannah, St. Elizabeth	Private	- Magnus Williams Alias Steve Chef of 1076 Crossings Court, Stone Mountain Georgia United States	Purchase			Absolute				- Survey Plan Examination No. : 271102	2021-04-21
ASD000557	CM1136072-523	113607226	-	560.0 Square Meter	BURNT SAVANNAH CALLED GHETTO LANE	St. Elizabeth		Ghetto Lane, Burnt Savannah, St. Elizabeth	Private	- Maiziline Bevene Parchment Alias Bevene Housewife of Burnt Savannah District, Burnt Savannah P.A. St. Elizabeth Jamaica	Purchase			Absolute	Right of Way				2021-02-25
ASD000528	CM1136071-522	113607108	-	482.0 Square Meter	BURNT SAVANNAH CALLED GHETTO LANE	St. Elizabeth		Ghetto Lane, Burnt Savannah, St. Elizabeth	Private	- Maiziline Bevene Parchment Alias Bevene Housewife of Burnt Savannah District, Burnt Savannah P.A. St. Elizabeth Jamaica	Purchase			Absolute				- Property Tax Receipts - Marriage Certificate	2021-02-10
ASD000578	CM1136072-523	113607256	-	1063.0 Square Meter	BURNT SAVANNAH CALLED GHETTO LANE	St. Elizabeth		Ghetto Lane, Burnt Savannah, St. Elizabeth	Private	- Makeda Foster Compliance Officer of Berrydale District, Porus P.O. Manchester Jamaica	Inheritance			Qualified				- Death Certificate	2021-03-23
ASD000544	CM1136040-521	113604001	-	746.0 Square Meter	BURNT SAVANNAH CALLED GHETTO LANE	St. Elizabeth		Mother Vie Lane, Burnt Savannah, St. Elizabeth	Private	- Marcia Robinson Unemployed of Burnt Savannah District, Burnt Savannah P.A. St. Elizabeth Jamaica	Inheritance			Absolute				- Survey Plan Examination No. : 247891 - Property Tax Receipts	2021-02-19

<div><div><div>NATIONAL LAND AGENCY</div></div><div><div>ADJUDICATION RECORD</div><div>PURSUANT TO SECTION 8A (1) (e) and 8A (1) (g) OF THE REGISTRATION OF TITLES CADASTRAL MAPPING AND TENURE CLARIFICATION (SPECIAL PROVISIONS) ACT</div></div></div>																			
SYSTEMATIC ADJUDICATION AREA : PARTS OF BURNT SAVANNAH CALLED 500 LANE AND GHETTO LANE. St. Elizabeth																			
LAND INFORMATION										PERSONAL DETAILS				OCCUPANCY DETAILS					
APPLICATION NO.	CADASTRAL MAP NUMBER	CADASTRAL MAP PARCEL NUMBER	LAND VALUATION NUMBER	AREA	PLACE	PARISH	VOLUME/FO LIO	PROPERTY ADDRESS	NATURE OF PARCEL	OWNER(S) DETAILS	NATURE BY WHICH LAND WAS ACQUIRED	NATURE OF OWNER DISABILITY	NAME, ADDRESS AND OCCUPATION OF GUARDIAN	NATURE OF TITLE	DETAILS OF ENCUMBRANCES	RESTRICTIONS ON POWER TO DEAL WITH LAND	DETAILS OF PERSON ENTITLED TO BENEFIT OF RESTRICTION	DOCUMENTS PRESENTED	DATE OF COMPLETION OF APPLICATION FORM
ASD000583	CM1136040-521	113604002	-	1001.0 Square Meter	BURNT SAVANNAH CALLED GHETTO LANE	St. Elizabeth		Mother Vie Lane, Burnt Savannah, St. Elizabeth	Private	- Melbert Lushington Robinson Businessman of 6220 Lansdowne Avenue, Philadelphia Pennsylvania United States	Gift			Absolute				- Survey Plan Examination No. : 247891 - Property Tax Receipts	2021-03-23
ASD000605	CM1136072-523	113607239	-	5900.0 Square Meter	BURNT SAVANNAH CALLED GHETTO LANE	St. Elizabeth		Ghetto Lane, Burnt Savannah, St. Elizabeth	Private	- Micheal Coley Alias Eli Carpenter of Burnt Savannah District, Burnt Savannah P.A. St. Elizabeth Jamaica	Inheritance			Qualified					2021-04-22
ASD000546	CM1136040-521	113604007	-	181.0 Square Meter	BURNT SAVANNAH CALLED GHETTO LANE	St. Elizabeth		Mother Vie Lane, Burnt Savannah, St. Elizabeth	Private	- Migrel Recordio Powell Carpenter of Burnt Savannah District, Burnt Savannah P.A. St. Elizabeth Jamaica	Gift			Absolute				- Survey Plan Examination No. : - - Property Tax Receipts	2021-02-19
ASD001035	CM1136071-522	113607103	-	2040.0 Square Meter	BURNT SAVANNAH CALLED GHETTO LANE	St. Elizabeth		Ghetto Lane, Burnt Savannah, St. Elizabeth	Private	- Moses Blake Retiree of 152 Victoria Street, Willenhall West Midlands United Kingdom	Purchase			Absolute					2021-05-09
ASD000552	CM1136071-522	113607107		593.0 Square Meter	BURNT SAVANNAH CALLED GHETTO LANE	St. Elizabeth		Ghetto Lane, Burnt Savannah, St. Elizabeth	Private	- Na-Fitzroy Goss Chef of Burnt Savannah District, Burnt Savannah P.A. St. Elizabeth Jamaica - Jason Jason Folkes Farmer of Burnt Savannah District, Burnt Savannah P.A. St. Elizabeth Jamaica - Benjamin Barrett Student born the 2nd day of August, 2007 of Burnt Savannah District, Burnt Savannah P.A. St. Elizabeth Jamaica	Inheritance			Absolute				- Property Tax Receipts - Death Certificate - Birth Certificate	2021-02-25
ASD000550	CM1136040-521	113604020	-	392.0 Square Meter	BURNT SAVANNAH CALLED GHETTO LANE	St. Elizabeth		Mother Vie Lane, Burnt Savannah, St. Elizabeth	Private	- Nicola Angella Swinton Minott Farmer of Burnt Savannah District, Burnt Savannah P.A. St. Elizabeth Jamaica	Gift			Absolute				- Property Tax Receipts - Death Certificate	2021-02-19
ASD000549	CM1136040-521	113604018	-	60000.0 Square Meter	BURNT SAVANNAH CALLED GHETTO LANE	St. Elizabeth		Mother Vie Lane, Burnt Savannah, St. Elizabeth	Private	- Nicola Angella Swinton Minott Farmer of Burnt Savannah District, Burnt Savannah P.A. St. Elizabeth Jamaica	Gift			Absolute				- Property Tax Receipts - Death Certificate	2021-02-19
ASD000529	CM1136072-523	113607213	-	1242.0 Square Meter	BURNT SAVANNAH CALLED GHETTO LANE	St. Elizabeth		Ghetto Lane, Burnt Savannah, St. Elizabeth	Private	- Omar Seyan Robinson Bus Operator of Burnt Savannah District, Burnt Savannah P.A. St. Elizabeth Jamaica	Gift			Absolute				- Property Tax Receipts - Death Certificate	2021-02-10
ASD000576	CM1136020-520	113602031	-	454.0 Square Meter	BURNT SAVANNAH CALLED 500 LANE	St. Elizabeth		500 Lane, Burnt Savannah, St. Elizabeth	Private	- Oneil Leroy Grindly Auto mechanic of Burnt Savannah District, Burnt Savannah P.A. St. Elizabeth Jamaica	Purchase			Absolute					2021-03-23
ASD000568	CM1136020-520	113602038	-	1018.0 Square Meter	BURNT SAVANNAH CALLED 500 LANE	St. Elizabeth		500 Lane, Burnt Savannah, St. Elizabeth	Private	- Patricia Elouise Martin Retiree of Burnt Savannah District, Burnt Savannah P.A. St. Elizabeth Jamaica	Purchase			Absolute					2021-03-18
ASD000535	CM1136020-520	113602011	-	577.0 Square Meter	BURNT SAVANNAH CALLED 500 LANE	St. Elizabeth		500 Lane, Burnt Savannah, St. Elizabeth	Private	- Paul Oliver Dixon Alias Memory Farmer of Burnt Savannah District, Burnt Savannah P.A. St. Elizabeth Jamaica	Gift			Absolute				- Property Tax Receipts	2021-02-17
ASD000596	CM1136072-523	113607210	-	1995.0 Square Meter	BURNT SAVANNAH CALLED GHETTO LANE	St. Elizabeth		Ghetto Lane, Burnt Savannah, St. Elizabeth	Private	- Peter Casmore Thomas Alias Banja Farmer of Burnt Savannah District, Burnt Savannah P.A. St. Elizabeth Jamaica - Paul Leslie Thomas Alias Bolt Farmer of Burnt Savannah District, Burnt Savannah P.A. St. Elizabeth Jamaica - Delroy Anthony Thomas Alias Erkie Chef of 840 Marllyn Road, Philidephia Pennsylvania United States				Absolute					2021-04-21
ASD000512	CM1136072-523	113607228	-	1287.0 Square Meter	BURNT SAVANNAH CALLED GHETTO LANE	St. Elizabeth		Ghetto Lane, Burnt Savannah, St. Elizabeth	Private	- Richard Daley Farmer of Burnt Savannah District, Burnt Savannah P.A. St. Elizabeth Jamaica	Gift			Absolute	Right of Way				2021-02-05
ASD000599	CM1136072-523	113607231	-	1074.0 Square Meter	BURNT SAVANNAH CALLED GHETTO LANE	St. Elizabeth		Ghetto Lane, Burnt Savannah, St. Elizabeth	Private	- Richard Sylvester Williams Farmer of Burnt Savannah District, Burnt Savannah P.A. St. Elizabeth Jamaica	Gift			Absolute					2021-04-21
ASD000598	CM1136072-523	113607230	-	1896.0 Square Meter	BURNT SAVANNAH CALLED GHETTO LANE	St. Elizabeth		Ghetto Lane, Burnt Savannah, St. Elizabeth	Private	- Richard Sylvester Williams Farmer of Burnt Savannah District, Burnt Savannah P.A. St. Elizabeth Jamaica	Gift			Absolute					2021-04-21
ASD000590	CM1136040-521	113604025	-	2425.0 Square Meter	BURNT SAVANNAH CALLED GHETTO LANE	St. Elizabeth		Mother Vie Lane, Burnt Savannah, St. Elizabeth	Private	- Roy Decosta Ramsay Farmer of Burnt Savannah District, Burnt Savannah P.A. St. Elizabeth Jamaica	Inheritance			Absolute				- Property Tax Receipts	2021-03-25

<div><div><div><div><div><div></div></div></div><div><div><div></div><div><div>NLA</div></div></div><div><div><div>NATIONAL LAND AGENCY</div></div></div></div></div></div><div><div><div><div><div></div></div><div><div>ADJUDICATION RECORD</div></div><div><div>PURSUANT TO SECTION 8A (1) (e) and 8A (1) (g) OF THE REGISTRATION OF TITLES CADASTRAL MAPPING AND TENURE CLARIFICATION (SPECIAL PROVISIONS) ACT</div></div></div></div></div></div>																			
SYSTEMATIC ADJUDICATION AREA : PARTS OF BURNT SAVANNAH CALLED 500 LANE AND GHETTO LANE. St. Elizabeth																			
LAND INFORMATION										PERSONAL DETAILS			OCCUPANCY DETAILS						
APPLICATION NO.	CADASTRAL MAP NUMBER	CADASTRAL MAP PARCEL NUMBER	LAND VALUATION NUMBER	AREA	PLACE	PARISH	VOLUME/FO LIO	PROPERTY ADDRESS	NATURE OF PARCEL	OWNER(S) DETAILS	NATURE BY WHICH LAND WAS ACQUIRED	NATURE OF OWNER DISABILITY	NAME, ADDRESS AND OCCUPATION OF GUARDIAN	NATURE OF TITLE	DETAILS OF ENCUMBRANCES	RESTRICTIONS ON POWER TO DEAL WITH LAND	DETAILS OF PERSON ENTITLED TO BENEFIT OF RESTRICTION	DOCUMENTS PRESENTED	DATE OF COMPLETION OF APPLICATION FORM
ASD000589	CM1136040-521	113604024	-	1317.0 Square Meter	BURNT SAVANNAH CALLED GHETTO LANE	St. Elizabeth		Mother Vie Lane, Burnt Savannah, St. Elizabeth	Private	- Roy Decosta Ramsay Farmer of Burnt Savannah District, Burnt Savannah P.A. St. Elizabeth Jamaica	Inheritance			Absolute				- Property Tax Receipts	2021-03-25
ASD000515	CM1136020-520	113602039	-	409.0 Square Meter	BURNT SAVANNAH CALLED 500 LANE	St. Elizabeth		500 Lane, Burnt Savannah, St. Elizabeth	Private	- Shaneka Rennay Williams Alias Poochy Farmer of Burnt Savannah District, Burnt Savannah P.A. St. Elizabeth Jamaica	Gift			Absolute					2021-02-10
ASD001044	CM1136040-521	113604004	-	1074.0 Square Meter	BURNT SAVANNAH CALLED 500 LANE	St. Elizabeth		500 Lane, Burnt Savannah, St. Elizabeth	Private	- Sid Thomas Motor Vehicle Mechanic of 60 Ashwell Gardens Nottingham United Kingdom - Leroy Thomas Furniture Maker of 74B Ringwood Road, Walthamstow London(UK) United Kingdom - Denise Thomas A&E Receptionist of 8140 Cleary Blvd, Apt. 1403, Plantation Florida United States	Inheritance			Qualified					2021-05-15
ASD000504	CM1136020-520	113602041	-	1044.0 Square Meter	BURNT SAVANNAH CALLED 500 LANE	St. Elizabeth		500 Lane, Burnt Savannah, St. Elizabeth	Private	- Stallyn Melbourne Brown Counsellor of Burnt Savannah District, Burnt Savannah P.A. St. Elizabeth Jamaica	Purchase	- Mental Disorder	- Rema Dunkley-Mike Farmer of Burnt Savannah District, Burnt Savannah P.A. St. Elizabeth	Qualified				- Property Tax Receipts	2021-02-04
ASD000600	CM1136072-523	113607211	-	803.0 Square Meter	BURNT SAVANNAH CALLED GHETTO LANE	St. Elizabeth		Ghetto Lane, Burnt Savannah, St. Elizabeth	Private	- Terence Thomas Alias Rocka Mason of Burnt Savannah District, Burnt Savannah P.A. St. Elizabeth Jamaica	Inheritance			Absolute					2021-04-21
ASD000507	CM1136020-520	113602023	-	1296.0 Square Meter	BURNT SAVANNAH CALLED 500 LANE	St. Elizabeth		500 Lane, Burnt Savannah, St. Elizabeth	Private	- Tom Ian Jones Construction Worker of Burnt Savannah District, Burnt Savannah P.A. St. Elizabeth Jamaica	Purchase			Absolute				- Survey Plan Examination No. : 284806	2021-02-04
ASD000572	CM1136072-523	113607248	-	302.0 Square Meter	BURNT SAVANNAH CALLED GHETTO LANE	St. Elizabeth		Ghetto Lane, Burnt Savannah, St. Elizabeth	Private	- Valda James Retiree of Slipe District, Slipe P.A. St. Elizabeth Jamaica - Donna Beverley James Housewife of Burnt Savannah District, Burnt Savannah P.A. St. Elizabeth Jamaica - Wayne Donovan James Alias Shorty Mason of Burnt Savannah District, Burnt Savannah P.A. St. Elizabeth Jamaica - Carolyn Annmarie James Alias Bloom Farmer of Burnt Savannah District, Burnt Savannah P.A. St. Elizabeth Jamaica	Inheritance			Absolute				- Marriage Certificate	2021-03-18
ASD000571	CM1136072-523	113607247	-	327.0 Square Meter	BURNT SAVANNAH CALLED GHETTO LANE	St. Elizabeth		Ghetto Lane, Burnt Savannah, St. Elizabeth	Private	- Valda James Retiree of Slipe District, Slipe P.A. St. Elizabeth Jamaica - Donna Beverley James Housewife of Burnt Savannah District, Burnt Savannah P.A. St. Elizabeth Jamaica - Wayne Donovan James Alias Shorty Mason of Burnt Savannah District, Burnt Savannah P.A. St. Elizabeth Jamaica - Carolyn Annmarie James Alias Bloom Farmer of Burnt Savannah District, Burnt Savannah P.A. St. Elizabeth Jamaica	Inheritance			Absolute				- Death Certificate - Marriage Certificate	2021-03-18
ASD000569	CM1136072-523	113607249	-	833.0 Square Meter	BURNT SAVANNAH CALLED GHETTO LANE	St. Elizabeth		Ghetto Lane, Burnt Savannah, St. Elizabeth	Private	- Valda James Retiree of Slipe District, Slipe P.A. St. Elizabeth Jamaica - Wayne Donovan James Alias Shorty Mason of Burnt Savannah District, Burnt Savannah P.A. St. Elizabeth Jamaica - Donna Beverley James Housewife of Burnt Savannah District, Burnt Savannah P.A. St. Elizabeth Jamaica - Carolyn Annmarie James Alias Bloom Farmer of Burnt Savannah District, Burnt Savannah P.A. St. Elizabeth Jamaica	Inheritance			Absolute				- Death Certificate - Marriage Certificate	2021-03-18
ASD000580	CM1136020-520	113602048	-	417.0 Square Meter	BURNT SAVANNAH CALLED 500 LANE	St. Elizabeth		500 Lane, Burnt Savannah, St. Elizabeth	Private	- Vannessa Andrea Dixon Vendor of Burnt Savannah District, Burnt Savannah P.A. St. Elizabeth Jamaica	Possession			Qualified					2021-03-23
ASD000517	CM1136020-520	113602047	-	715.0 Square Meter	BURNT SAVANNAH CALLED 500 LANE	St. Elizabeth		500 Lane, Burnt Savannah, St. Elizabeth	Private	- Vannessa Andrea Dixon Vendor of Burnt Savannah District, Burnt Savannah P.A. St. Elizabeth Jamaica	Gift			Absolute					2021-02-10
	CM1136020-520	113602029	-	2232.0 Square Meter	BURNT SAVANNAH CALLED 500 LANE	St. Elizabeth		500 Lane, Burnt Savannah, St. Elizabeth	Private	- Vevelyn Patricia Thomas Alias Ms Mercy Farmer of Burnt Savannah District, Burnt Savannah P.A. St. Elizabeth Jamaica	Inheritance			Qualified				- Property Tax Receipts - Last Will and Testament of : Veneta Kilburn	2021-04-21



ADJUDICATION RECORD

PURSUANT TO SECTION 8A (1) (e) and 8A (1) (g) OF THE
REGISTRATION OF TITLES CADASTRAL MAPPING AND TENURE CLARIFICATION (SPECIAL PROVISIONS) ACT

SYSTEMATIC ADJUDICATION AREA : PARTS OF BURNT SAVANNAH CALLED 500 LANE AND GHETTO LANE. St. Elizabeth

	LAND INFORMATION									PERSONAL DETAILS		OCCUPANCY DETAILS							
APPLICATION NO.	CADASTRAL MAP NUMBER	CADASTRAL MAP PARCEL NUMBER	LAND VALUATION NUMBER	AREA	PLACE	PARISH	VOLUME/FO LIO	PROPERTY ADDRESS	NATURE OF PARCEL	OWNER(S) DETAILS	NATURE BY WHICH LAND WAS ACQUIRED	NATURE OF OWNER DISBAILITY	NAME, ADDRESS AND OCCUPATION OF GUARDIAN	NATURE OF TITLE	DETAILS OF ENCUMBRANCES	RESTRICTIONS ON POWER TO DEAL WITH LAND	DETAILS OF PERSON ENTITLED TO BENEFIT OF RESTRICTION	DOCUMENTS PRESENTED	DATE OF COMPLETION OF APPLICATION FORM
ASD000532	CM1136072-523	113607255	-	1023.0 Square Meter	BURNT SAVANNAH CALLED GHETTO LANE	St. Elizabeth		Ghetto Lane, Burnt Savannah, St. Elizabeth	Private	- Yvonne Nordaree Powell Farmer of Burnt Savannah District, Burnt Savannah P.A. St. Elizabeth Jamaica	Purchase			Absolute				- Survey Plan Examination No. : PE326174 - Property Tax Receipts - Receipt	2021-02-12
ASD000577	CM1136072-523	113607242	-	817.0 Square Meter	BURNT SAVANNAH CALLED GHETTO LANE	St. Elizabeth		Ghetto Lane, Burnt Savannah, St. Elizabeth	Private	- Yvonne Jones Retiree of Burnt Savannah District, Burnt Savannah P.A. St. Elizabeth Jamaica	Gift			Absolute					2021-03-23

This Adjudication Record is comprised of an Adjudication Register of claims to ownership rights and interests in parcels of land and a Cadastral Map. Some parcels have been excluded from the Adjudication Record as a result of requests for further subdivision of parcels, encroachments, parcels already registered etc..

The Adjudication Record was displayed in the Systematic Adjudication Area on

June 4, 2021

 and shall remain on display for a period of THIRTY (30) days.

During this period, the Senior Director, Adjudication Services may amend any minor error or omission not materially affecting the interest of any person. Therefore, any Applicant who considers the Adjudication Record to be contain minor inaccuracies or omissions, may within THIRTY (30) days of the date of display of the Adjudication Record, submit the details of such inaccuracies or omissions in the prescribed Form and manner.

Any person who objects to an Applicant's claim to ownership rights and interests in a parcel of land on the Adjudication Record, may within THIRTY (30) days of the date of display of the said Record submit the grounds for objection in the prescribed Form and manner.

The prescribed Forms (Amendment of the Adjudication Record or Objection to the Adjudication Record) are available at any National Land Agency office or via the Agencys website at: www.nla.gov.jm

All Requests for Amendment of the Adjudication Record or Objection to the Adjudication Record must be submitted using the prescribed Form to the Senior Director, Adjudication Services at:

National Land Agency
8 Ardenne Road
Kingston 10
Saint Andrew



Senior Director,
Adjudication Services:

Display Date:

June 4, 2021

CM 1136072-523

Scale 1:1,000 Cadastral Map

JAMAICA

LAMP BLOCK 36 - SHEET 072

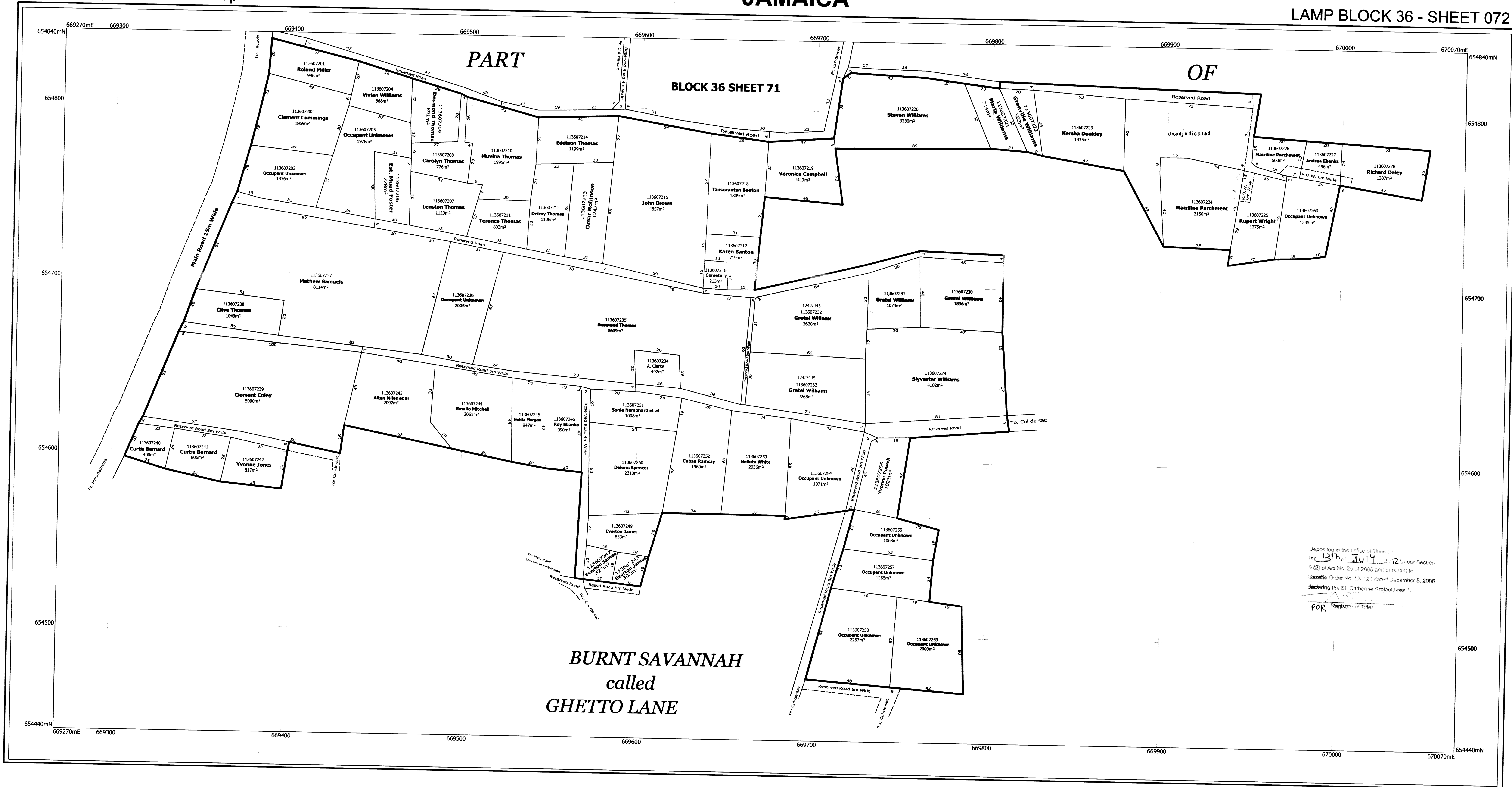

Deposited in the Office of Titles on the 13th of July 2012 under Section 8 (2) of Act No. 25 of 2005 and pursuant to Gazette Order No. LK 121 dated December 5, 2006, declaring the St. Catherine Project Area 1.

FOR Registrar of Titles

LEGEND

Volume and Folio
Property Boundary
Deposited Plan Boundary
Gully/Drain/River
Registered Boundary

1234/567

SURVEY DATUM: JAD2001

Projection: Lambert Conical Orthomorphic with one Standard Parallel
Spheroid: WGS84 (JAD2001 National Grid System)
Unit of Measurement: Metre
Origin: 77° 00' 00" W of Greenwich
False Co-ordinates of Origin: 750,000m Easting 650,000m Northing
Scale Factor at Origin: 1.000

Certified that the area delineated on this map form part of LAMP St. Elizabeth Project Area 1
Gazetted at Order No. dated July 20, 2009
Dated the 30th of April 2012
C. R. Edwards
Director of Survey

CADASTRAL MAP
PART OF
BURNT SAVANNAH
called
GHETTO LANE
St. Elizabeth

metres 20 10 0 20 40 60 80 100 metres
SCALE: 1cm to 10m R.F. 1/1000
GRID INTERVAL 100m



Compiled by GEOLAND Ltd from Plans annexed to Registered Titles, Plans by the Survey Department, Cadastral Records certified of the Survey Department and Field observation of Property boundaries.
Compilation Date: July 18, 2011
Users noting errors or omissions are asked to Return map to the Surveys and Mapping Division and it will be replaced.

NLA CADMAP
CHECKED
C. R. Edwards
For Director of Surveys
Date 2012/04/30

Parcel Count Table	
No. of Clarification Parcels	1
No. of Regularisation Parcels	59
Total no. of Parcels	60

Example of Parcel Numbering

Parish	11
Block	36
Sheet	072
Parcel	60
Parcel #	113607260

PREPARED BY
GEOLAND TITLE LIMITED
52-60 GRENADA CRESCENT,
KINGSTON 5
St. Andrew, Jamaica, W.I.
TEL: 876 908-0192

GEOLAND
TITLE LIMITED

L 11 36 072

CM 1136071-522

Scale 1:1,000 Cadastral Map

JAMAICA

LAMP BLOCK 36 - SHEET 071

PART

OF

BLOCK 36 SHEET 040

BURNT SAVANNAH

BLOCK 36 SHEET 072

called

GHETTO LANE

Deposited in the Office of Titles on
the 13th of July 2012 Under Section
5 (2) of Act No. 25 of 2005 and pursuant to
Gazette Order No. LN 121 dated December 5, 2008,
declaring the St. Catherine's Project Area 1.
For Registrar of Titles

LEGEND

Volume and Folio
Property Boundary
Deposited Plan Boundary
Gully/Drain/River
Registered Boundary

1234/567

SURVEY DATUM : JAD2001

Projection: Lambert Conical Orthomorphic with
Spheroid: one Standard Parallel
Unit of Measurement: WGS84 (JAD2001 National Grid System)
Origin: Metre
False Co-ordinates of Origin: 77° 00' 00" W of Greenwich
Scale Factor at Origin: 750,000m Easting
650,000m Northing
1,000

Verified that the area delineated on this
form part of LAMP St. Elizabeth Project Area 1
Gazetted at Order No. dated July 20, 2009
Dated the 30th of July 2012
C.R. Edwards
Director of Survey

metres 20 10 0 20 40 60 80 100 metres
SCALE : 1cm To 10m R.F. 1/1000
GRID INTERVAL 100m

CADASTRAL MAP
PART OF
BURNT SAVANNAH
called
GHETTO LANE
St. Elizabeth

GN



Compiled by GEOLAND Ltd.
from Plans annexed to Registered Titles, Plans
by the Survey Department, Cadastral Records
certified of the Survey Department and Field
observation of Property boundaries.
Compilation Date: July 18, 2011
Users noting errors or omissions are asked
to Return map to the Surveys and Mapping
Division and it will be replaced.

NLA CADMAP

CHECKED

C.R. Edwards

For Director of Surveys

Date 2012/04/30

Parcel Count Table	
No. of Clarification Parcels	0
No. of Regularisation Parcels	14
Total no. of Parcels	14

Example of Parcel Numbering

Parish	11	
Block	36	
Sheet	071	
Parcel		14
Parcel #	113607114	

SURVEYOR: Patrick Hendricks
PATRICK HENDRICKS
COMMISSIONED SURVEYOR
GEOLAND TITLE LIMITED
DATE: 2012/04/30

PREPARED BY
GEOLAND TITLE LIMITED
52-60 GRENADA CRESCENT,
KINGSTON 5
St. Andrew, Jamaica, W.I.
TEL. 876 908-0192

GEOLAND
TITLE LIMITED

L 1136 071

CM 1136040-521

Scale 1:1,000 Cadastral Map

JAMAICA

LAMP BLOCK 36 - SHEET 040

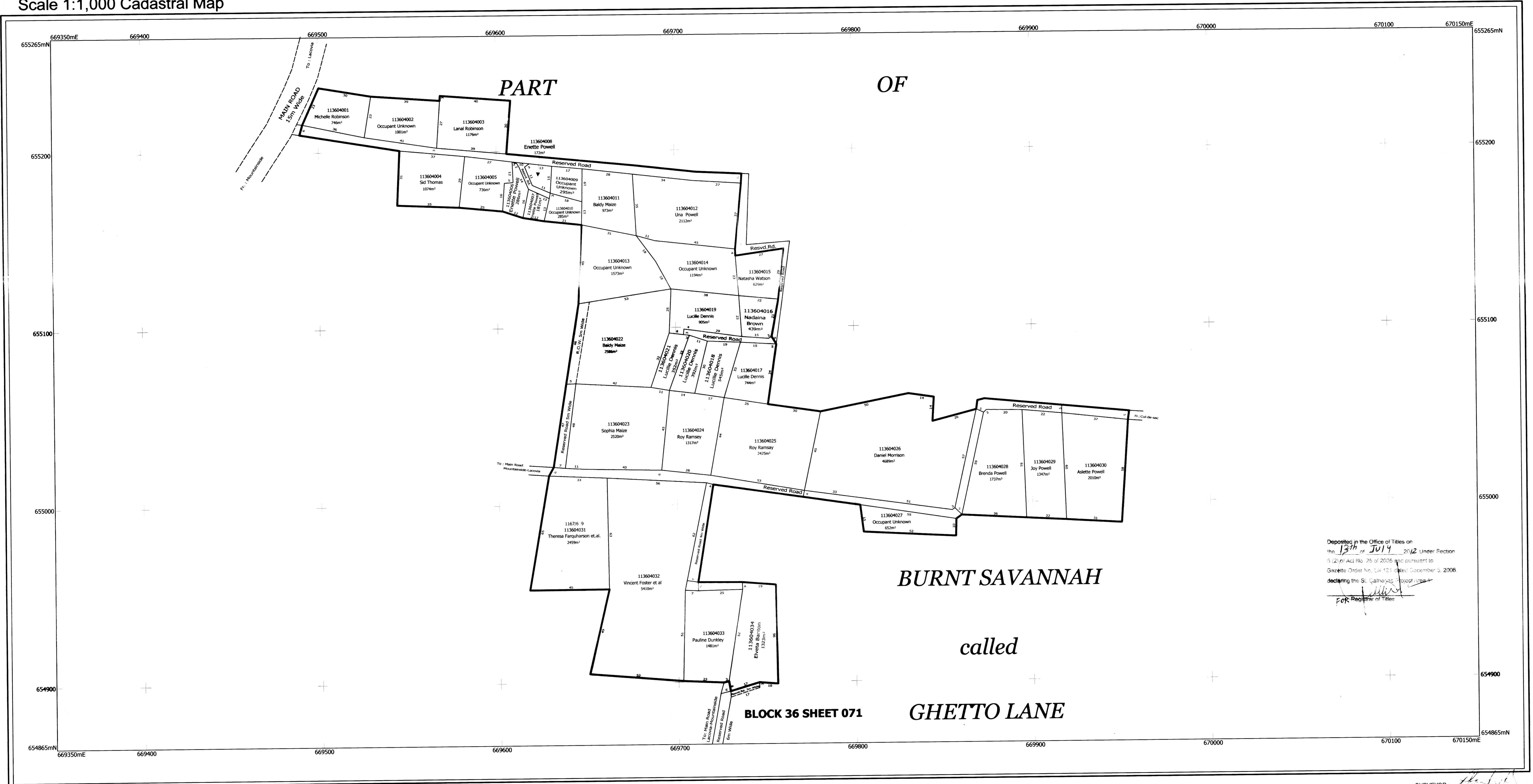

Deposited in the Office of Titles on the 13th of July 2012 Under Section 5 (2) of Act No. 25 of 2005 and pursuant to Gazette Order No. L14 121 dated December 9, 2006 declaring the St. Catherine's Project as a For Registrar of Titles

LEGEND

Volume and Folio
Property Boundary
Deposited Plan Boundary
Gully/Drain/River
Registered Boundary

1234/567

SURVEY DATUM : JAD2001

Projection: Lambert Conical Orthomorphic with one Standard Parallel
Spheroid: WGS84 (JAD2001 National Grid System)
Unit of Measurement: Metre
Origin: 77° 00' 00" W of Greenwich
False Co-ordinates of Origin: 750,000m Northing
Scale Factor at Origin: 1.000

Certified that the area delineated on this map form part of LAMP St. Elizabeth Project Area 1
Gazetted at Order No. dated July 20, 2009
Dated the 30th of April 2012
C. R. E. Director of Survey

CADASTRAL MAP
PART OF
BURNT SAVANNAH
called GHETTO LANE
St. Elizabeth

metres 20 10 0 20 40 60 80 100 metres

SCALE : 1cm To 10m R.F. 1/1000
GRID INTERVAL 100m



Compiled by GEOLAND Ltd.
from Plans annexed to Registered Titles, Plans
by the Survey Department, Cadastral Records
certified of the Survey Department and Field
observation of Property boundaries.
Compilation Date: July 18, 2011
Users noting errors or omissions are asked
to Return map to the Surveys and Mapping
Division and it will be replaced.

NLA CADMAP
CHECKED

C. R. E. Director of Survey
Date 2012/04/30

Parcel Count Table	
No. of Clarification Parcels	0
No. of Regularisation Parcels	34
Total no. of Parcels	34

Example of Parcel Numbering

Parish	11		
Block	36		
Sheet	040		
Parcel		35	
Parcel #	113604035		

PREPARED BY
GEOLAND TITLE LIMITED
52-60 GRENADA CRESCENT,
KINGSTON 5
St. Andrew, Jamaica, W.I.
TEL. 876 908-0192

GEOLAND
TITLE LIMITED

L 11 36 040
11/165335

JAMAICA

CM 1136020-520

LAMP BLOCK 36 - SHEET 020

PART

OF

BURNT SAVANNAH
called
500 LANE

Deposited in the Office of Titles on
the 13th of July 2012 Under: Section
6 (2) of Act No. 25 of 2005 and pursuant to
Gazette Order No. LN 121 dated December 5, 2006,
declaring the St. Catherine Project Area 1.

FOR Registrar of Titles

LEGEND

SURVEY DATUM : JAD2001

Projection: Lambert Conical Orthomorphic with one Standard Parallel
Spheroid: WGS84 (JAD2001 National Grid System)
Unit of Measurement: Metre
Origin: 77° 00' 00" W of Greenwich
18° 00' 00" N of the Equator
False Co-ordinates of Origin: 750,000m Easting
650,000m Northing
Scale Factor at Origin: 1.000

Certified that the area delineated on this map
form part of LAMP St. Elizabeth Project Area 1
Gazetted at Order No. _____ dated July 20, 2009
Dated the 30th of April 2012

C. R. Edwards
Director of Survey

SCALE : 1cm To 10m R.F 1/1000
GRID INTERVAL 100m

CADASTRAL MAP
PART OF
BURNT SAVANNAH
called
500 LANE
St. Elizabeth

GN



Compiled by GEOLAND Ltd.
from Plans annexed to Registered Titles, Plans
by the Survey Department, Cadastral Records
certified of the Survey Department and Field
observation of Property boundaries.

Users noting errors or omissions are asked to Return map to the Surveys and Mapping Division and it will be replaced.

NLA CADMAP

CHECKED
C. R. Edwards
For Director of Survey
Date 2012/04/30

Parcel Count Table	
No. of Clarification Parcels	
No. of Regularisation Parcels	5
Total no. of Parcels	5

Example of Parcel Numbering

Parish	11		
Block		36	
Sheet			020
Parcel			57
Parcel #	113602057		

SURVEYOR: Patrick Hendricks
PATRICK HENDRICKS
COMMISSIONED LAND SURVEYOR
GEOLAND TITLE LIMITED
DATE: 2/20/2012

PREPARED BY
GEOLAND TITLE LIMITED
2 BELMONT ROAD
KINGSTON 5
St. Andrew, Jamaica, W.I.
TEL. 876 908-0192



CP 1765334

L 11 36 020